



Equal=Press

PRESSURE DISTRIBUTION TEST KIT

EqualPress is a unique, affordable diagnostic tool available in a format of 21.25 x 24.50" sheets.

This tool allows the user to create a visual view of the distribution of pressure on the surface area of a circuit board in any specific lamination lay-up. You will witness firsthand the magnitude of pressure between any two contacting, mating, or impacting surfaces. Result takes three minutes to create in a cold press (ambient room temperature below 100°F at pressures anywhere between 350 - 1400 psi). The final film image illustrates a direct reflection of the lamination make-up as it exists (real time).

The sensor film is extremely thin (4 to 8 mils) which enables it to conform to curved surfaces and capture all topography differentials. The full sheet size means less or no cutting to match the film to the surface area of the circuit.

EqualPress is provided in a tube kit package that includes film to run two separate tests and will provide you a clean image as it relates to size.

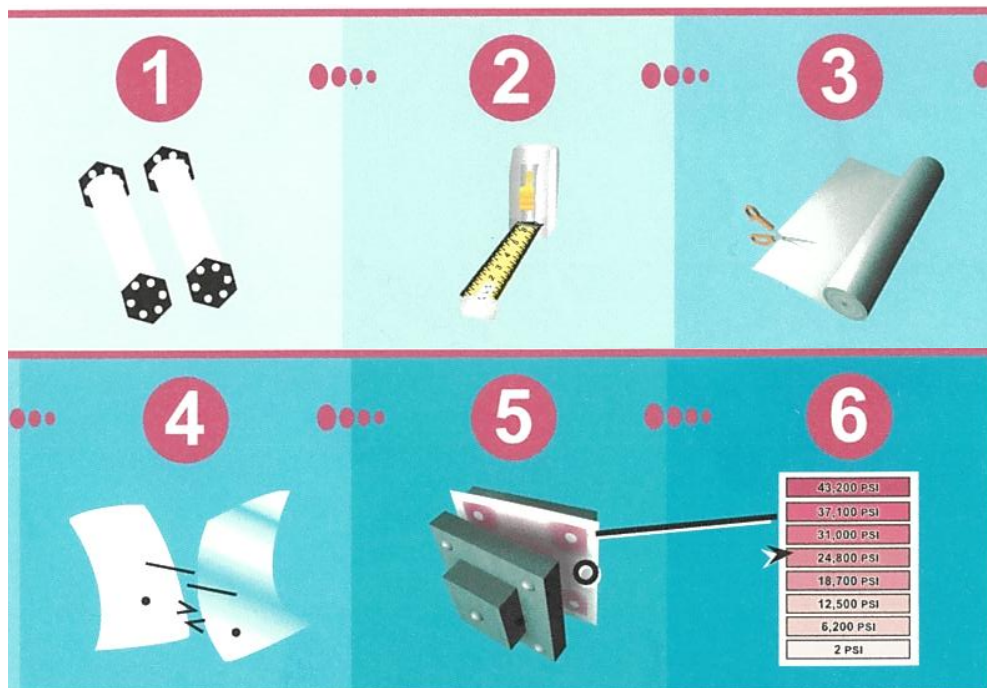

Finally, an easy-to-use kit to help diagnose potential problems. Poor tooling plate conditions, effect from inferior tooling pins, wear of press platen related to age can be identified and fixed. Inferior press pad conditions or misused remedies such as press pad re-use can be identified and fixed. This includes determining proper positioning of components of the total make-up to improve process yields. EqualPress offers a simple easy to use solution for diagnostics in your lamination press area.

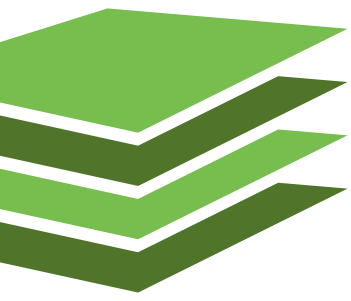

Equal-Press

PRESSURE DISTRIBUTION TEST KIT

Illustrations created by EqualPress below, show actual pressure magnitude of high and low pressure spots displayed by intensity of pink. They also show distribution of the pressure (equalization) across the total circuit board surface area in the lamination make-up. The impact from each specific use of Press Pads was included as it impacts each performance significantly.



TWO VIRGIN PRESS PADS TOP & BOTTOM OUTSIDE CAUL AND SEPARATOR PLATES

ONE USED, ONE VIRGIN RELEASE COATED PRESS PAD TOP & BOTTOM OUTSIDE CAUL AND SEPARATOR PLATES



TWO PLYS OF BIPLY POSITIONED WITH RELEASE SIDE ADJACENT TO CAUL AND SEPARATOR PLATES TOP & BOTTOM

BIPLY PLACED ADJACENT TO FLEX LAMINATION RELEASE SIDE ADJACENT TO SEPARATOR PLATE, NON-RELEASE SIDE OF PRESS PAD IS PLACED ADJACENT TO CONFORMAL RELEASE FILM

